



Republic of the Philippines
Province of Pampanga

Bids and Awards Committee

Provincial Capitol, City of San Fernando, (P) / (045) 435-5901

DEC 20 2024

RFQ No. **241298**

P.R. No. / Date / End User / Purpose:
(24-6271 12/18/2024 GO for G.O/Executive House use)

REQUEST FOR QUOTATION

Small Value Procurement

Company Name: _____
Address: _____
Tel. No.: _____

Please quote your lowest price for the requirements listed hereunder subject to the Terms and Conditions stated below and submit to this Office duly signed by you or your representative not later than **4:00 p.m. DEC 26 2024**

APPROVED BUDGET FOR
THE CONTRACT (ABC):
PHP 965,000.00

FRANCIS V. MASLOG
CHAIRPERSON
Bids and Awards Committee

TERMS AND CONDITIONS

- All quotations may be typewritten or handwritten, placed in a sealed envelope.
- All quotations shall be valid for one hundred twenty (120) calendar days from the deadline of the submission of the same.
- Any erasures or overwriting shall be valid only if they are signed or initialed by the supplier or its authorized representative.
- Interested suppliers are required to submit their valid current Mayor's Permit, PhilGEPS Registration Number, and Income/BIR Tax Return (for ABCs above P500,000.00) upon submission of quotation. In lieu of the Mayor's Permit and PhilGEPS Registration Number, the PhilGEPS Certificate of Platinum Membership may be submitted. For new businesses, submit the BIR Certificate of Registration and latest quarterly return or percentage tax..
- The applicable rate for late deliveries is one tenth (1/10) of one percent (1%) of the cost of the unperformed portion for everyday of delay.
- The Provincial Government of Pampanga reserves the right to accept or reject any quotation, and to annul the procurement process and reject all quotations at any time prior to contract award, without thereby incurring any liability to the affected supplier/s.
- The GPG also reserves the right to waive any required formality in the proposals received, and select the proposal which it determine to be the most advantageous to the government.

Item No.	Qty	Unit	Item Description	Unit Price	Total Price
1	1	unit	Drawers with 2 Doors and 9 Drawers for Satellite Office Executive House - Size: 1265 mm x 2800 mm x 45 mm (Modular) - Material: Marine Plywood : 12 mm with laminate : Calaccatta gold stone : Recessed Handle aluminum-gold - Drawers - Color Light oak wood with led light with 2 doors and 9 drawers Inclusive of installation (See attached drawing)		
2	1	unit	Sink Cabinet for Toilet and Bath on Conference Room 2 (Executive House) - Sink Cabinet: change grey laminate (3 door) Inclusive of installation (See attached drawing)		
3	1	unit	Sink Cabinet for Toilet and Bath - Sink Cabinet: change 2 doors : change grey laminate Inclusive of installation (See attached drawing)		
4	1	unit	Upper Door Cabinet for Executive office Pantry Area - Laminate into grey and remove handles - 6pcs upper door cabinet - Size: 49cm x 90cm - 6pcs lower door cabinet - Size: 44cm x 66cm Inclusive of installation (See attached drawing)		
5	1	unit	Toilet and Bath Cabinet Pantry Area Governor's Office and under counter cabinet - Approx. 85 cm (w) x 60cm (depth) x 410 cm (ht.) with grey laminate 2 doors with casement (Modular) Inclusive of installation (See attached drawing)		

No.	Qty	Unit	Item Description	Unit Price	Total Price
6	1	unit	Pantry Cabinet (Governor's Pantry) - Change laminate into grey - 14 pcs. Doors and change hinges to overlap conseld hinges remove handle - Upper Cabinet Size: 33cm x 86cm (Modular) - Lower Cabinet Size: 30cm x 56cm (Modular) Inclusive of installation (See attached drawing)		
7	1	unit	Grey Laminate and Solid Surface Stone Top for Counter Top and Splash Board 6 doors with cabinet for refrigerator and with 2 shelves - Dimension: 2100mm x 2320mm x 580mm - 3pcs Upper Cabinet with casement - 300mm depth (Modular) - 3pcs Lower Cabinet with casement - 450mm depth (Modular) Inclusive of installation (See attached drawing)		
8	1	unit	Pantry Doors for Pantry Lounge and Conference - Pantry doors change laminate into grey - Remove handle and change to overlap hinges - 6pcs Upper Cabinet Doors - 39cm x 90cm (Modular) - 6pcs Lower Cabinet Doors - 38cm x 65 cm (Modular) Inclusive of installation (See attached drawing)		
9	1	unit	Bar Top Calacatta Gold Quarts - 71" width x 48" ht (Modular) - Veneer Laminate for the Bar Counter change laminate for the cabinets all exterior parts - 4pcs Doors and outer framing Inclusive of installation		
10	40	pcs	Black and Gold Lining - Trimming matt black - Black for executive room with installation (Room 1) - Black for Satellite Office with installation - Black for Executive room with installation (Room 2) - Gold for Governor's Office with installation - Size: 6mm x 2m Inclusive of installation		
			TERMS OF REFERENCE: 1. The procuring entity reserves the right to conduct product testing/inspection to determine the fitness of the items being offered by prospective supplier/s.		
			AFTER SALES SERVICE: 1. Replacement of defective items within 24 hours upon notification by the end user.		
			Schedule of Requirements: - Delivery and Installation within ten (10) calendar days upon receipt of PO/NOA		
Total Lot Price					

Note: The winning supplier shall submit a duly signed and notarized Omnibus Sworn Statement prior to notice of award.

THE BIDS AWARDS COMMITTEE:

Having carefully read and accepted your Terms and Conditions, including the technical specifications, I/We offer to supply/deliver the item/s as noted above.

Supplier's authorized representative signature over printed name

Designation: _____

Contact No.: _____

Email Address.: _____

BAC CANVASSER

Jaq

KAPITOLYO PROJECT

Sto Nino, Capitol Compound, San Fernando, Pampanga

GOVERNOR'S OFFICE:
PANTRY



PANTRY

Prepared by: IDr. DMT & IDr. JRZ





PANTRY

Prepared by: IDr. DMT & IDr. JRZ

16



PANTRY

Prepared by: IDr. DMT & IDr. JRZ



PANTRY

Prepared by: IDR. DMT & IDR. JRZ

GOVERNOR'S OFFICE:
POWDER ROOM



POWDER ROOM

Prepared by: IDr. DMT & IDr. IRZ



POWDER ROOM

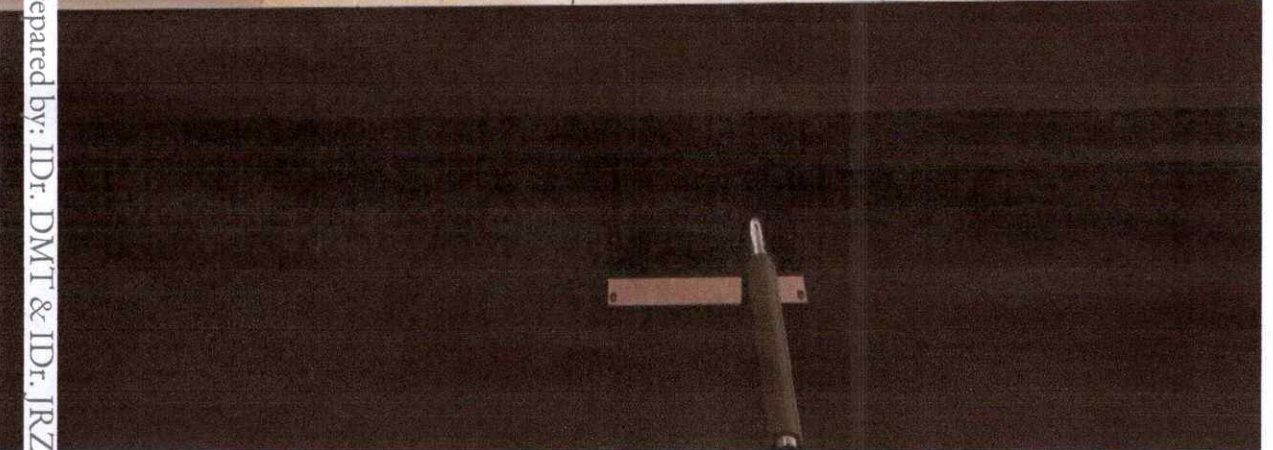

Prepared by: IDr. DMT & IDr. IRZ



POWDER ROOM

Prepared by: IDr. DMT & IDr. JRZ

GOVERNOR'S OFFICE:
TOILET & BATH



TOILET & BATH

Prepared by: IDr. DMT & IDr. JRZ



TOILET & BATH

Prepared by: IDr. DMT & IDr. JRZ



TOILET & BATH

Prepared by: IDr. DMT & IDr. JRZ

EXECUTIVE HOUSE

EXECUTIVE HOUSE: CONFERENCE - T&B

Sto Nino, Capitol Compound, San Fernando, Pampanga

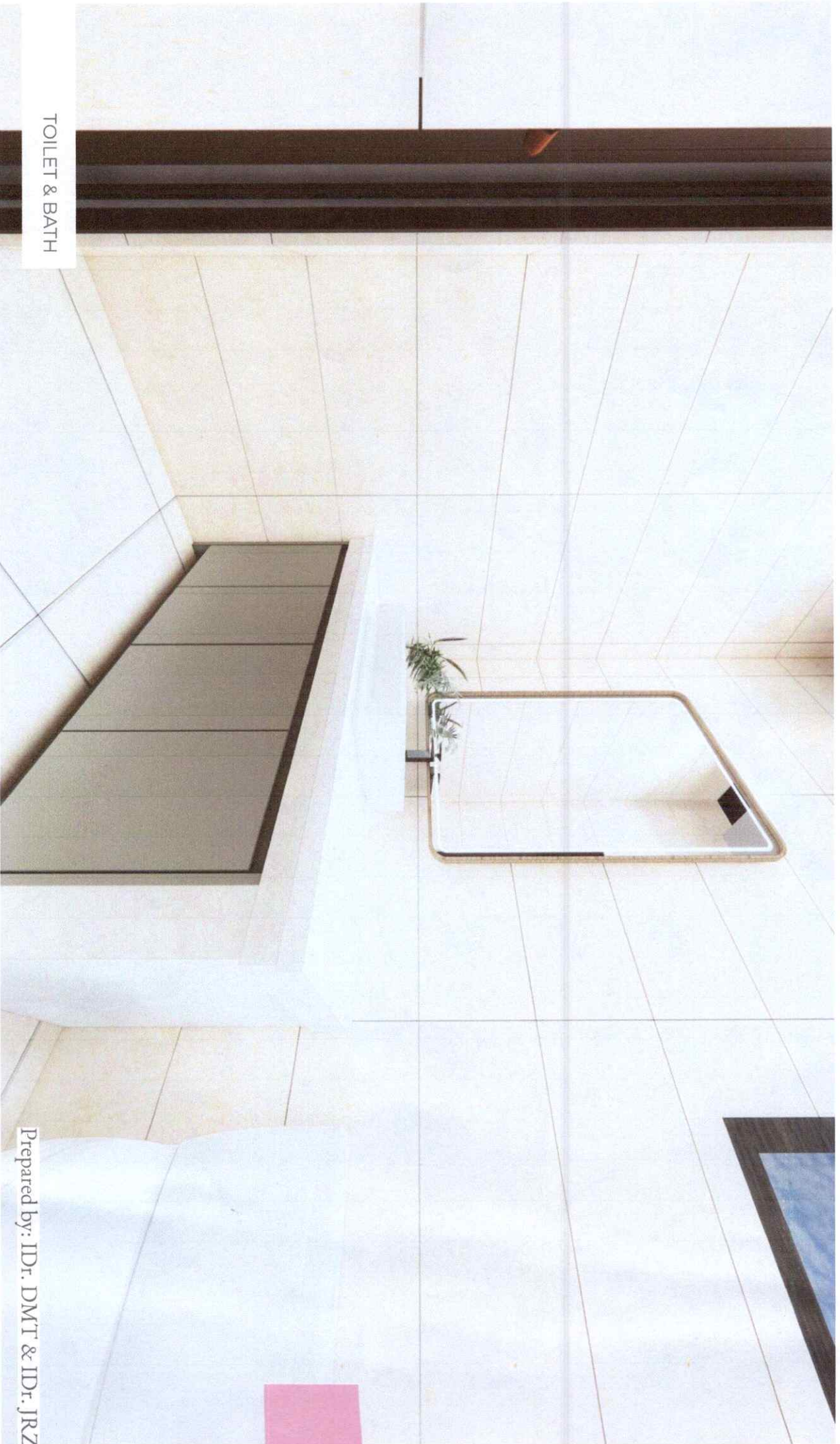

TOILET & BATH

Prepared by: IDR. DMT & IDR. JRZ



TOILET & BATH

Prepared by: IDr. DMT & IDr. JRZ



TOILET & BATH

Prepared by: IDr. DMT & IDr. JRZ



TOILET & BATH

EXECUTIVE HOUSE:
SATELLITE OFFICE



SATELLITE OFFICE



SATELLITE OFFICE



EXECUTIVE HOUSE:
CONFERENCE/LOUNGE



EXECUTIVE LOUNGE

Prepared by: IDr. DMT & IDr. JRZ

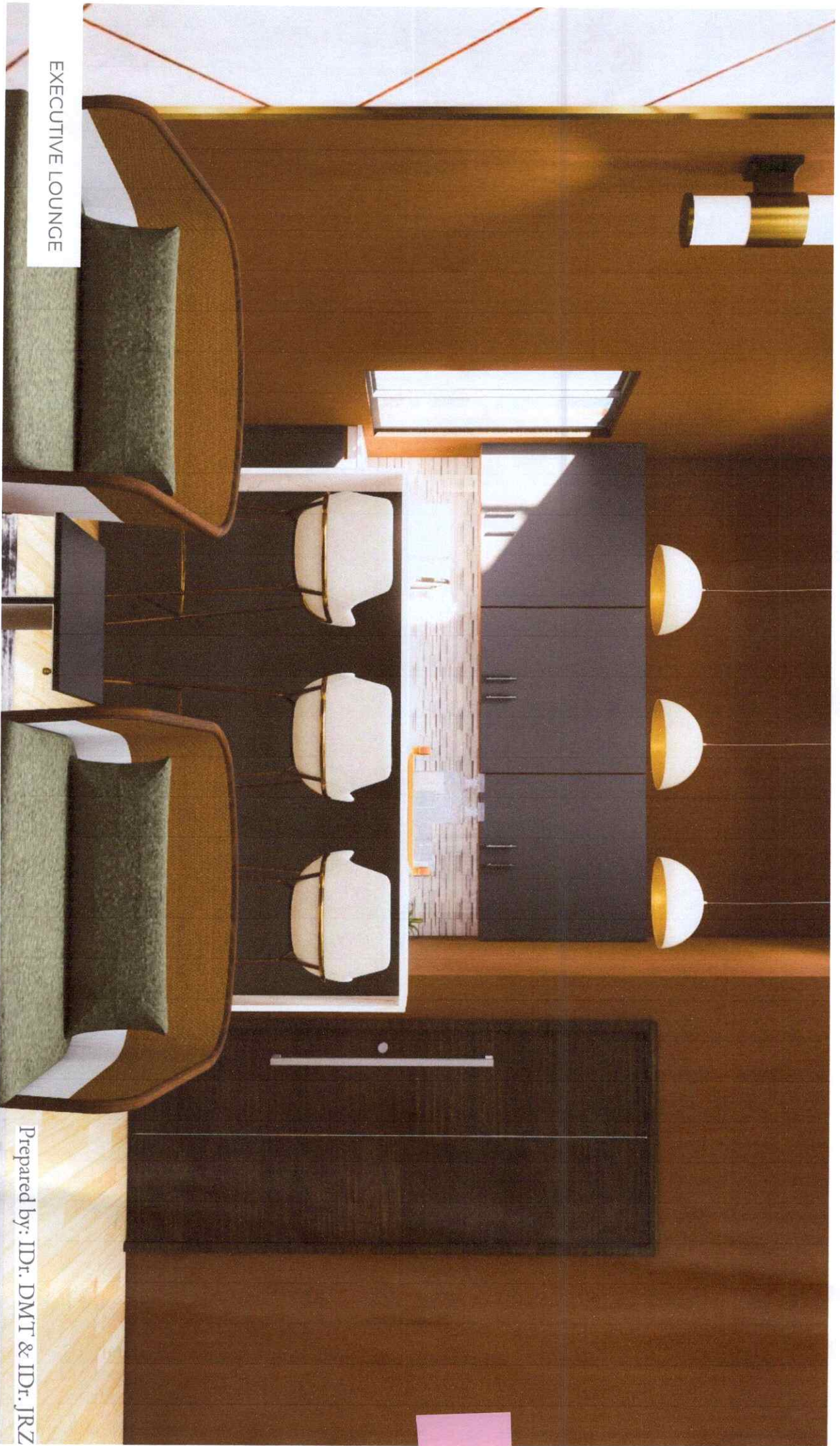

EXECUTIVE LOUNGE

Prepared by: IDr. DMT & IDr. JRZ

EXECUTIVE HOUSE:
PANTRY

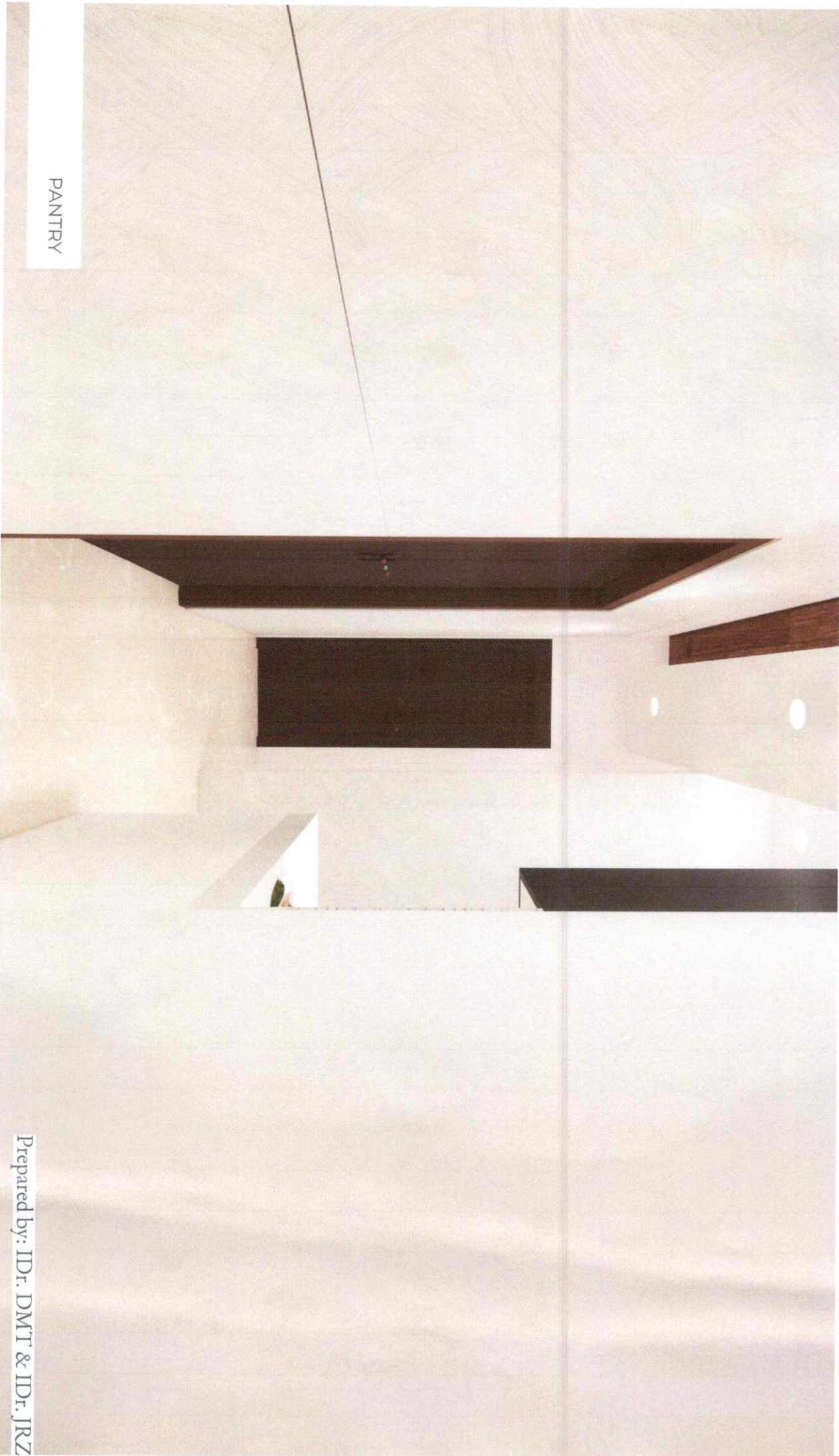

PANTRY

Prepared by: IDr. DMT & IDr. JRZ



PANTRY

Prepared by: IDr. DMT & IDr. J.RZ

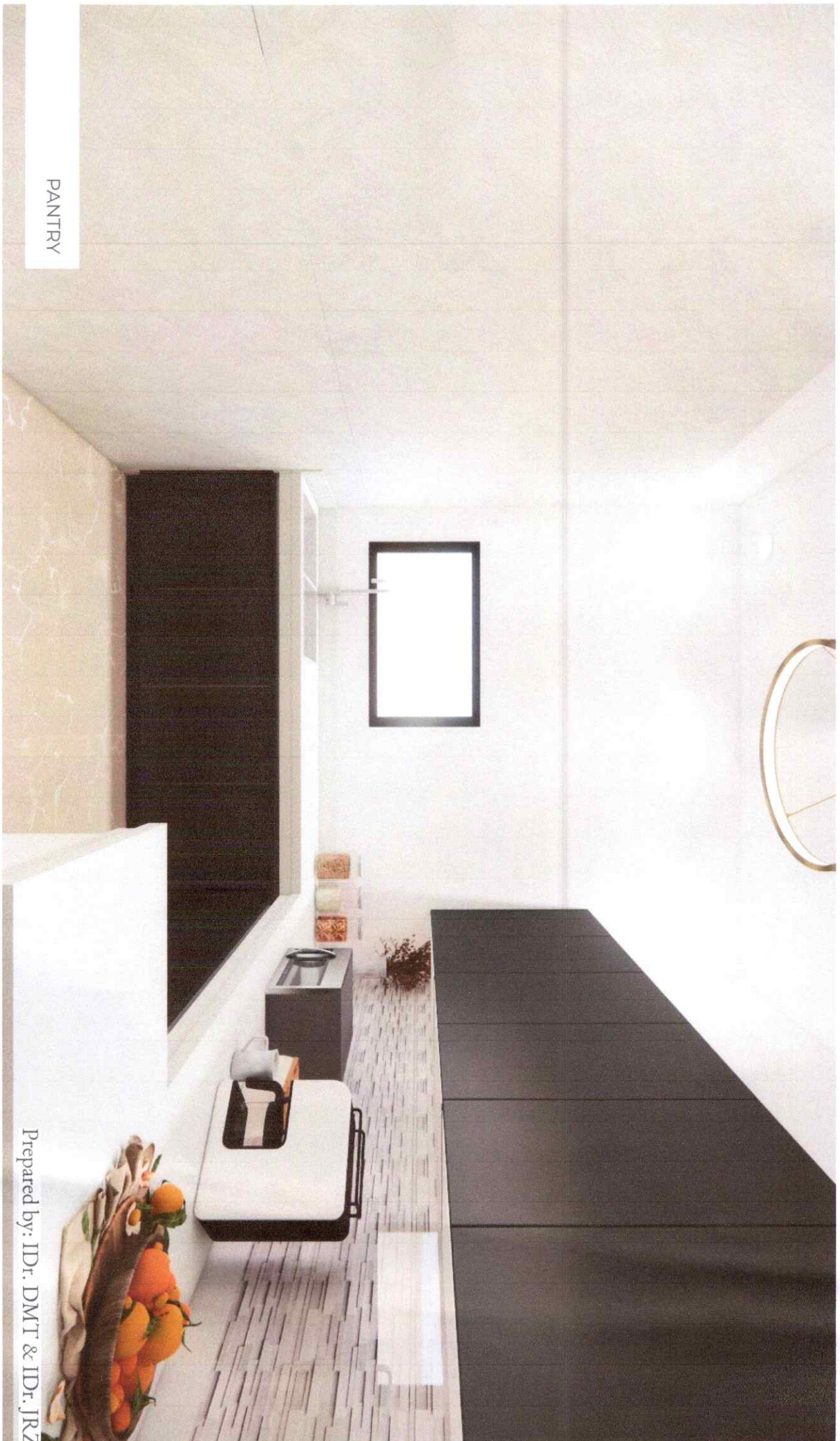

PANTRY

Prepared by: IDr. DMT & IDr. JRZ



PANTRY

Prepared by: IDr. DMT & IDr. JRZ



PANTRY

Prepared by: IDr. DMT & IDr. JRZ



PANTRY

Prepared by: IDr. DMT & IDr. JRZ