

ROAD PROFILE

SCALE 1:100

BEGINNING OF PROPOSED CHB LINED CANAL 0+000.00 BOTH SIDE

EXISTING PCCP

BEGINNING OF PROJECT STA. 0+000

END OF PROPOSED CHB LINED CANAL 0+204.70 BOTH SIDE

EXISTING PCCP

END OF PROPOSED PCCP STA. 0+204.70

STA. 0+000

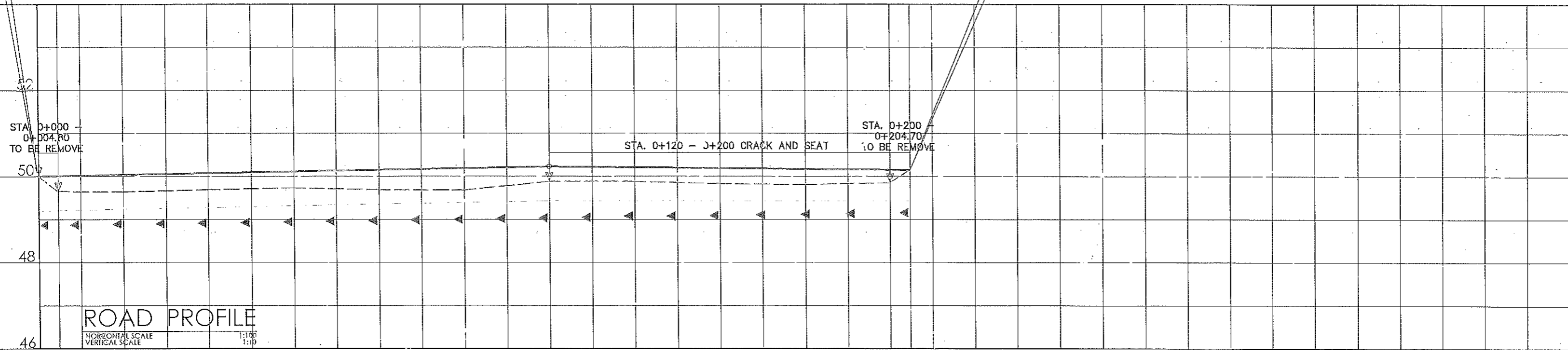

STATION	0+000	0+020	0+040	0+060	0+080	0+100	0+120	0+140	0+160	0+180	0+204.70
FINISH GRADE ELEVATION	50.00	50.04	50.08	50.12	50.15	50.19	50.23	50.21	50.19	50.17	50.15
EXISTING ELEVATION	50.00 49.65	49.64	49.69	49.73	49.69	49.68	49.88	49.88	49.83	49.81	49.85 50.15
INVERT ELEVATION	49.20	49.24	49.28	49.32	49.35	49.39	49.43	49.43	49.43	49.43	49.43

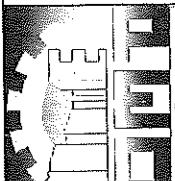
IMPLEMENTING AGENCY:	PROJECT TITLE:	PREPARED BY:	REVIEWED BY:	CHECKED BY:	SUBMITTED BY:	RECOMMENDING APPROVAL:	APPROVED BY:	SHEET CONTENT:	SHEET NO.:
 REPUBLIC OF THE PHILIPPINES PROVINCE OF PAMPANGA <b>PROVINCIAL ENGINEER'S OFFICE</b> CANTON COMPOUND, STO NINO, CITY OF SAN FERNANDO, PAMPANGA	IMPROVEMENT/CONCRETING OF BARANGAY ROAD LOCATION: SAN NICOLAS, CITY OF SAN FERNANDO, PAMPANGA	CHRISTINE V. MORALES ENGINEER I EDRALIN M. DANAN ENGINEER II	RAY P. MACASPAC ACTING CHIEF OF INVESTIGATION AND SURVEY SECTION	ESMERALDO T. GULAPA ENGINEER IV	WILFREDO A. MANALIPI ASSISTANT PROVINCIAL ENGINEER	OLIMPIO M. PANGAN PROVINCIAL ENGINEER	HON. DENNIS G. PINEDA GOVERNOR BY THE AUTHORITY OF THE GOVERNOR: ATTY. CHARLIE G. CHUA PROVINCIAL ADMINISTRATOR	AS SHOWN	01/07

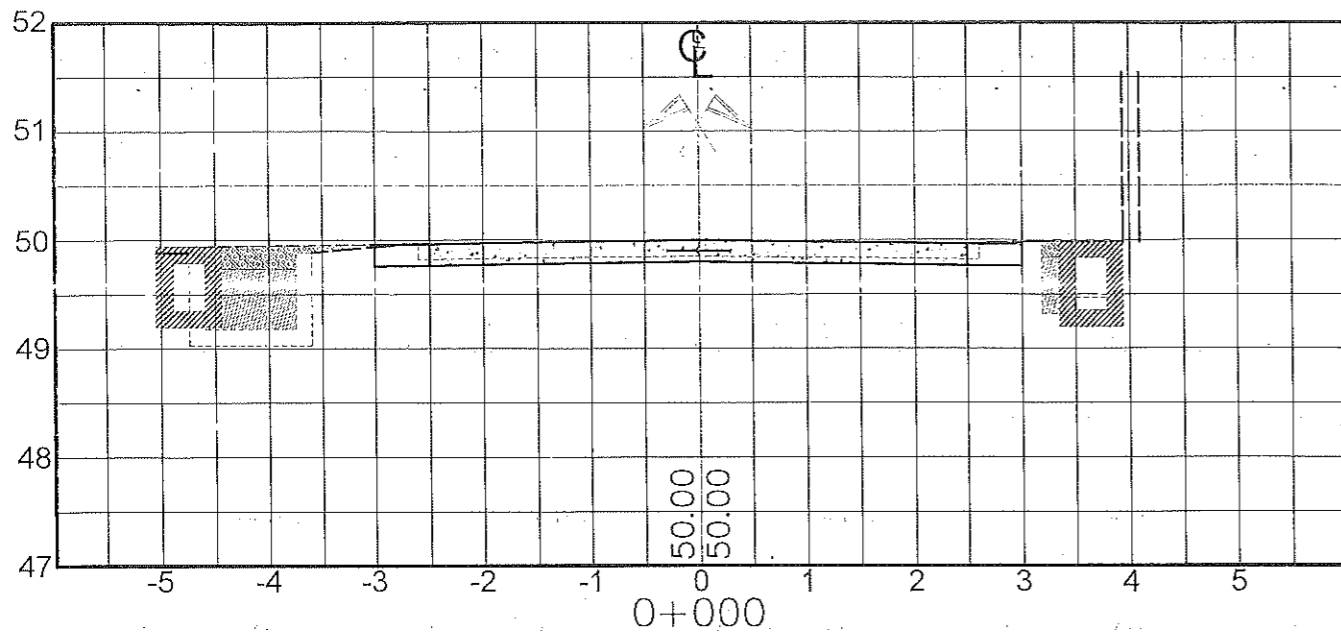

0+000  
 $ABC = 0.12m^2$   
 $A_{emb} = 0.32m^2$   
 $A_{exc} = 0.20m^2$

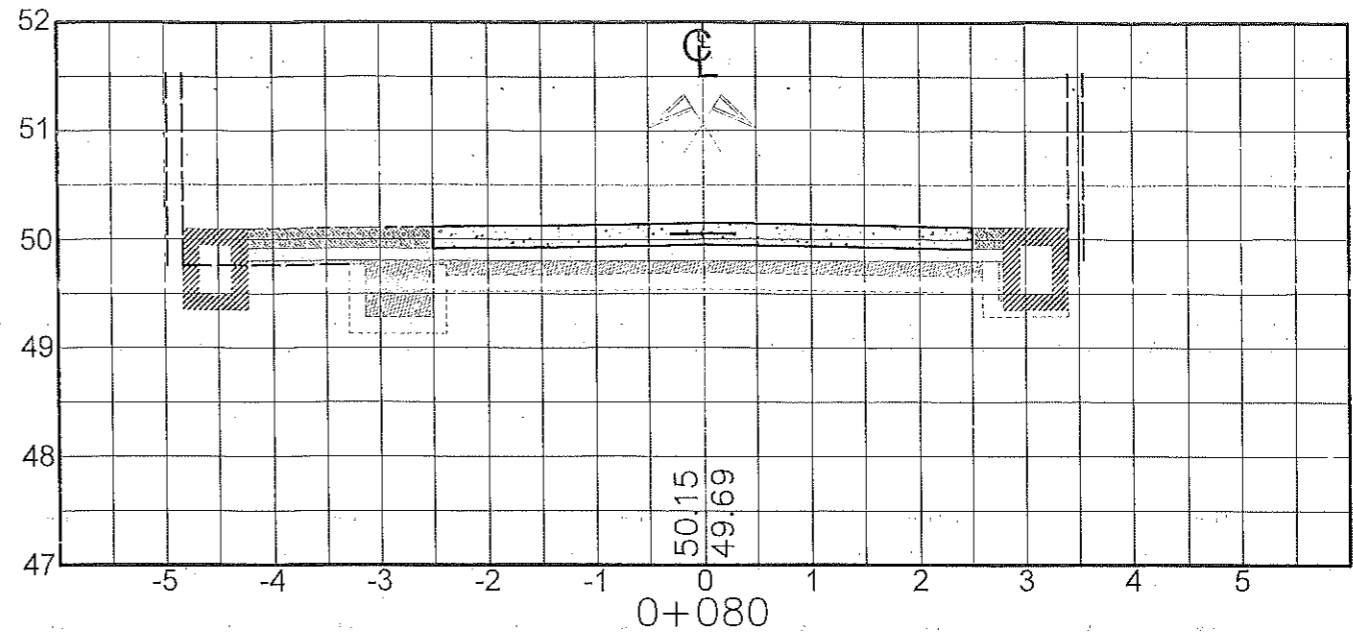

0+080  
 $ABC = 0.30m^2$   
 $A_{emb} = 0.86m^2$   
 $AsBC = 0.83m^2$   
 $A_{exc} = 0.40m^2$

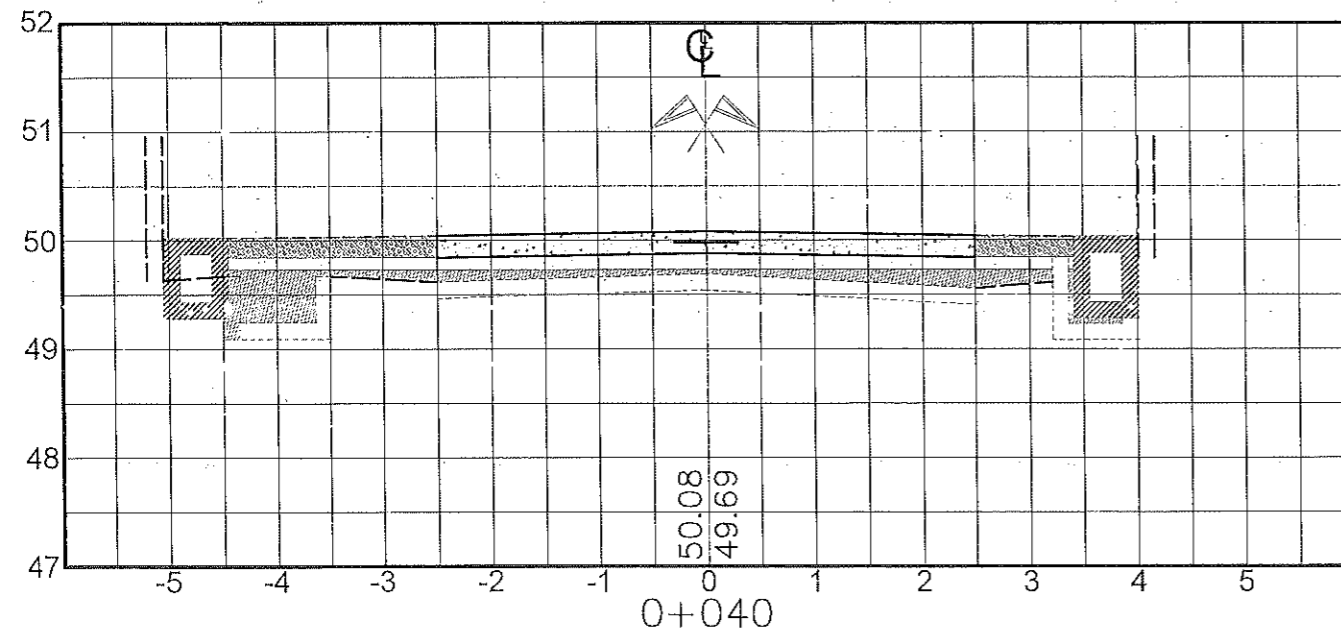

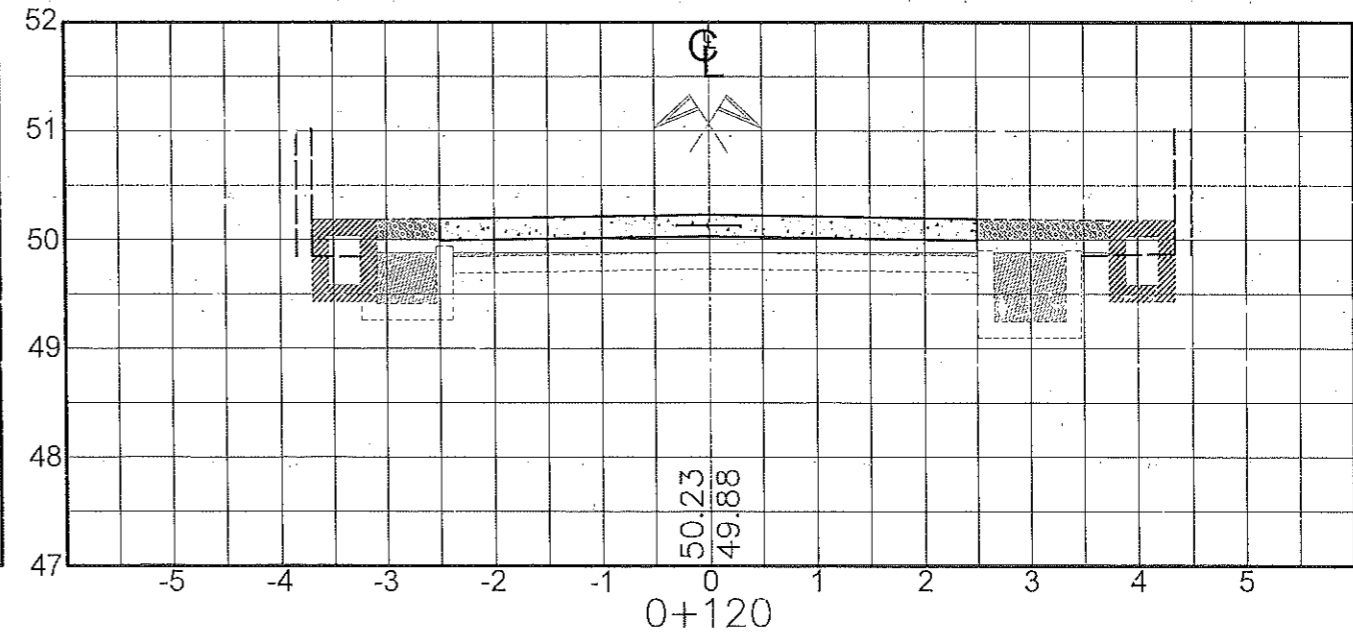

0+040  
 $ABC = 0.45m^2$   
 $A_{emb} = 1.02m^2$   
 $AsBC = 0.91m^2$   
 $A_{exc} = 0.21m^2$

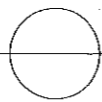

0+120  
 $ABC = 0.26m^2$   
 $A_{emb} = 0.65m^2$   
 $AsBC = 0.79m^2$   
 $A_{exc} = 0.52m^2$

ROAD SECTION  
 SCALE 1:60

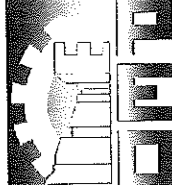
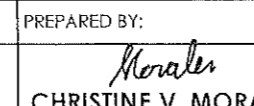
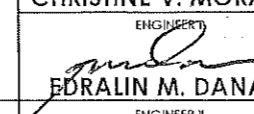
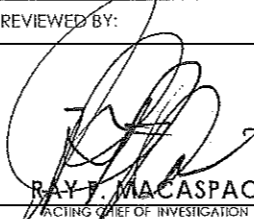
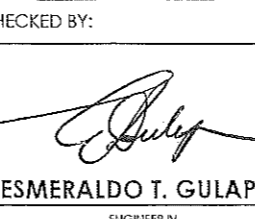
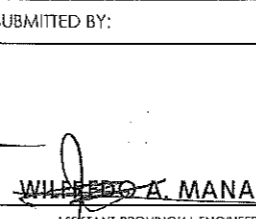

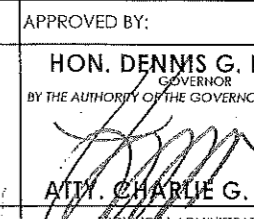
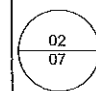
IMPLEMENTING AGENCY:  REPUBLIC OF THE PHILIPPINES PROVINCE OF PAMPANGA <b>PROVINCIAL ENGINEER'S OFFICE</b> <small>CAPITOL COMPOUND, SIO SINO, CITY OF SAN FERNANDO, PAMPANGA</small>	PROJECT TITLE: <b>IMPROVEMENT/CONCRETING          OF BARANGAY ROAD.</b> <small>LOCATION: SAN NICOLAS, CITY OF SAN FERNANDO, PAMPANGA</small>	PREPARED BY:  <b>CHRISTINE V. MORALES</b> <small>ENGINEER I</small>  <b>EDRALIN M. DANAN</b> <small>ENGINEER II</small>	REVIEWED BY:  <b>RAY T. MACASPAC</b> <small>ACTING CHIEF OF INVESTIGATION          AND SURVEY SECTION</small>	CHECKED BY:  <b>ESMERALDO T. GULAPA</b> <small>ENGINEER IV</small>	SUBMITTED BY:  <b>WILFREDO A. MANALILI</b> <small>ASSISTANT PROVINCIAL ENGINEER</small>	RECOMMENDING APPROVAL:  <b>OLIMPIO M. PANGAN</b> <small>PROVINCIAL ENGINEER</small>	APPROVED BY: <b>HON. DENNIS G. PINEDA</b> <small>GOVERNOR</small> BY THE AUTHORITY OF THE GOVERNOR:  <b>ATTY. CHARLIE G. CHUA</b> <small>PROVINCIAL ADMINISTRATOR</small>	SHEET CONTENT: AS SHOWN	SHEET NO: 
---	--	---	---	--	---	---	--	----------------------------	--

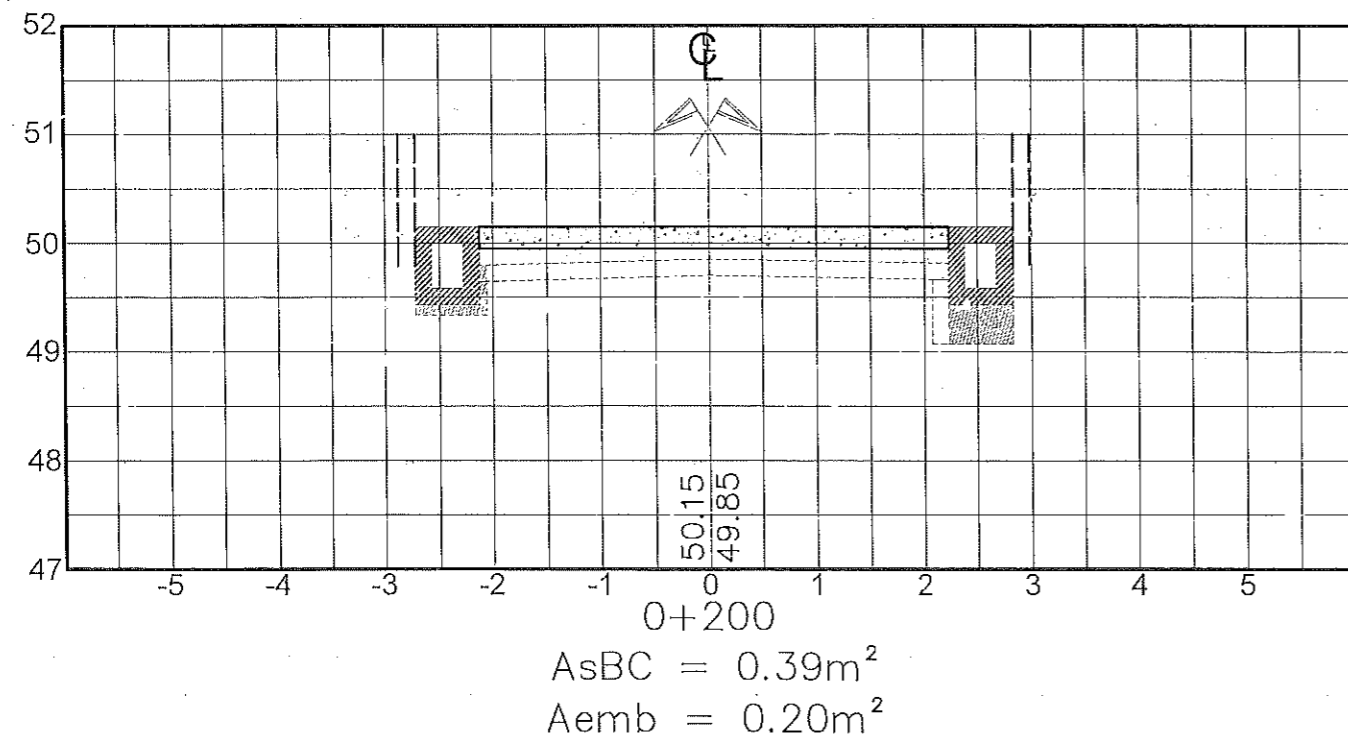
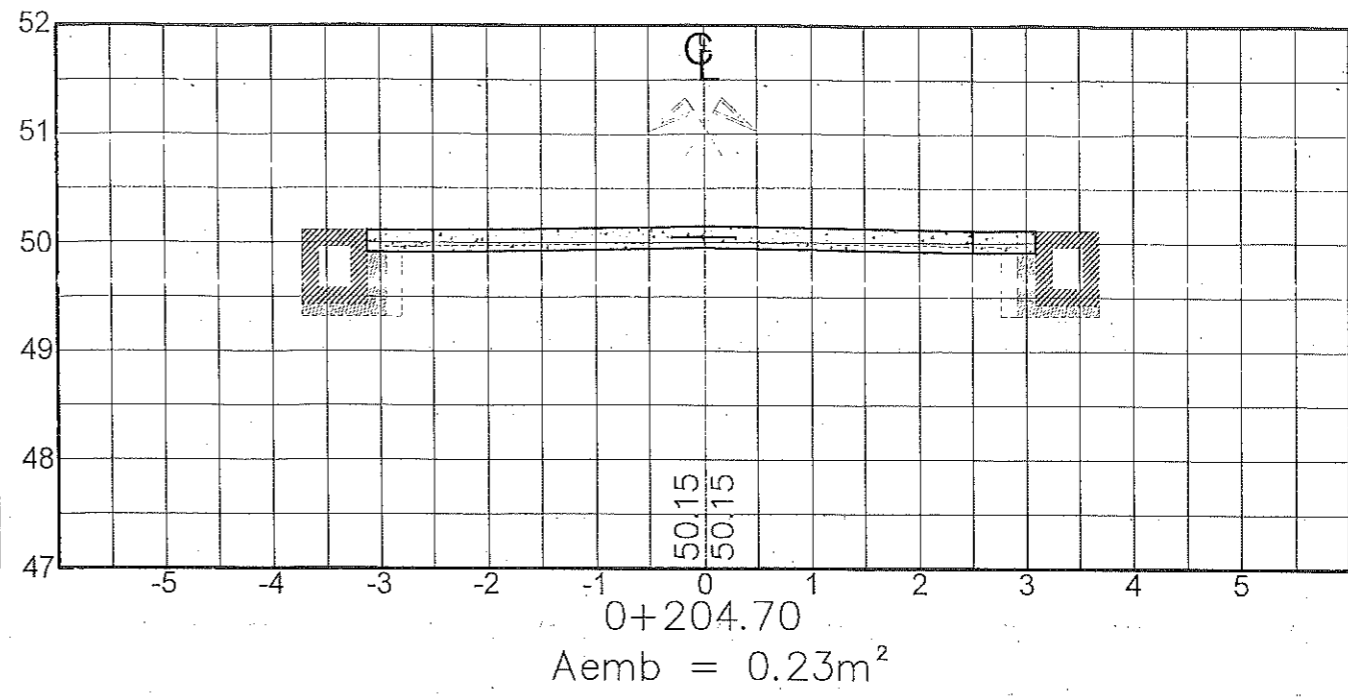
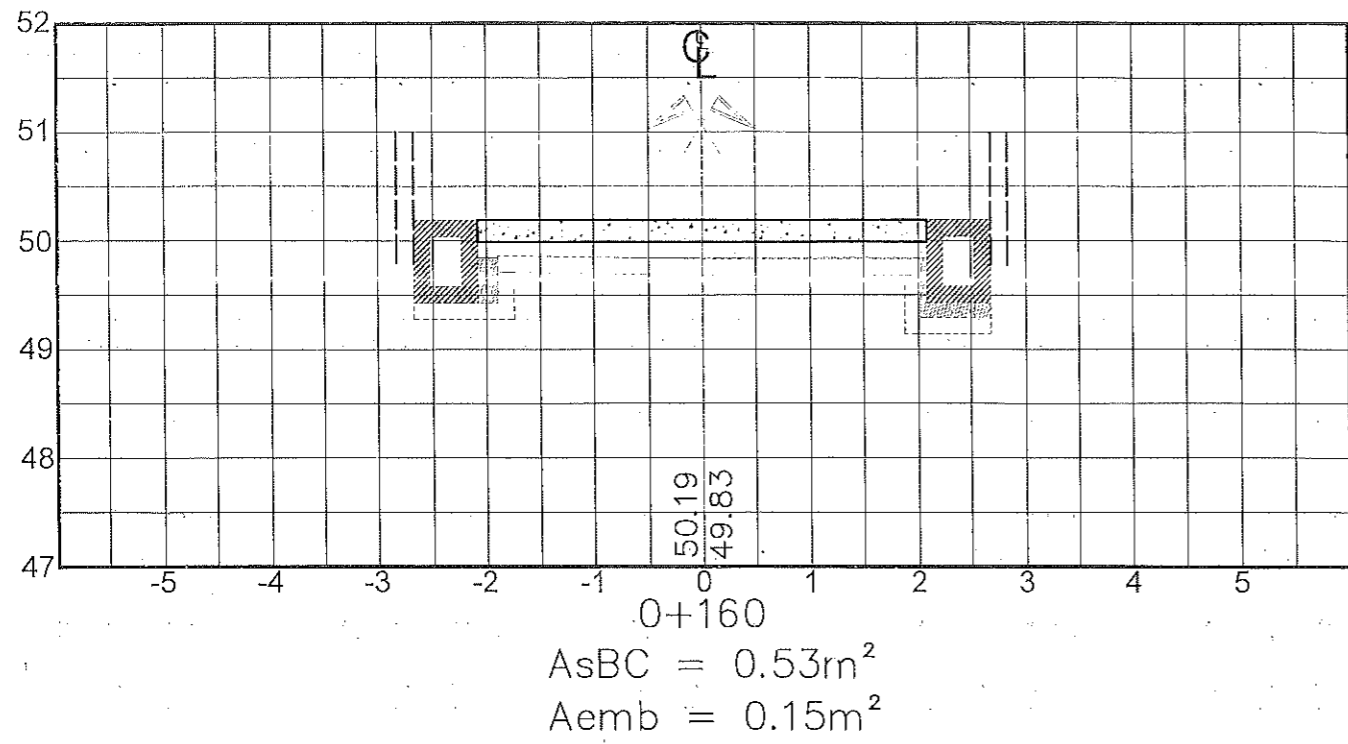

ROAD SECTION

SCALE 1:60

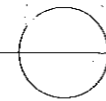

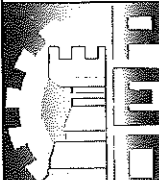

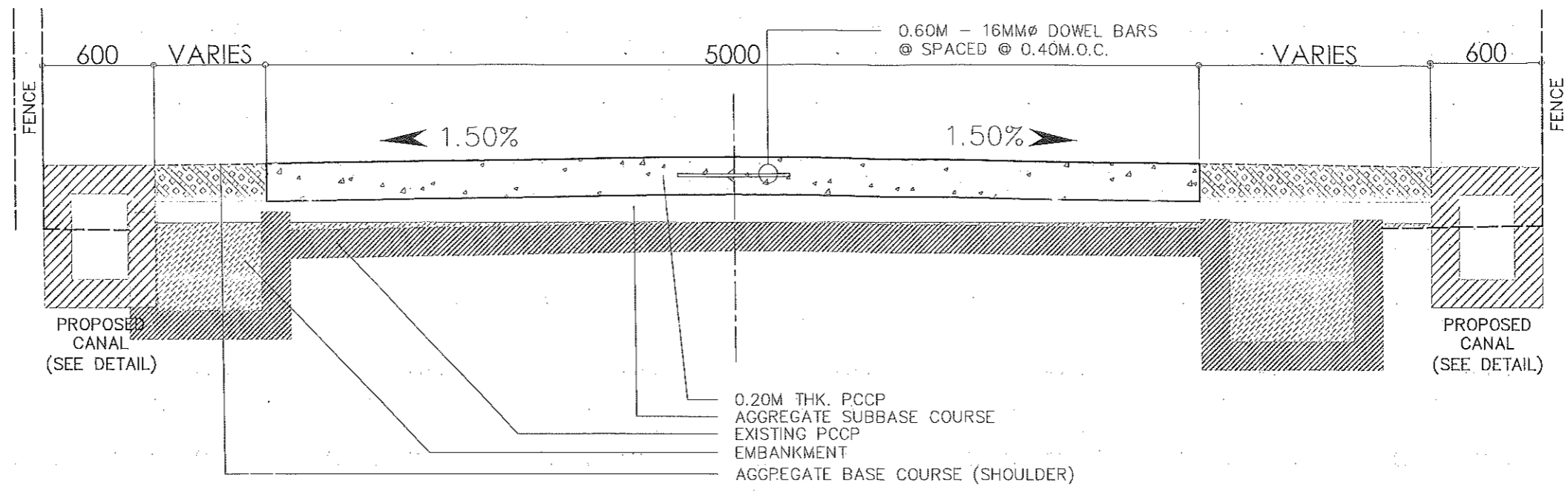
IMPLEMENTING AGENCY:	PROJECT TITLE:	PREPARED BY:	REVIEWED BY:	CHECKED BY:	SUBMITTED BY:	RECOMMENDING APPROVAL:	APPROVED BY:	SHEET CONTENT:	SHEET NO:
 <p>REPUBLIC OF THE PHILIPPINES            PROVINCE OF PAMPANGA  <b>PROVINCIAL ENGINEER'S OFFICE</b>            CASTOL COMPOUND, 570 NINO, CITY OF SAN FERNANDO, PAMPANGA</p>	<p>IMPROVEMENT/CONCRETING            OF BARANGAY ROAD</p> <p>LOCATION: SAN FICOFAS, CITY OF SAN FERNANDO, PAMPANGA</p>	<p><i>Morales</i>  <b>CHRISTINE V. MORALES</b>            ENGINEER I</p> <p><i>Danan</i>  <b>EDRALIN M. DANAN</b>            ENGINEER II</p>	<p><i>Macaspac</i>  <b>RAY B. MACASPAC</b>            ACTING CHIEF OF INVESTIGATION            AND SURVEY SECTION</p>	<p><i>Gulapa</i>  <b>ESMERALDO T. GULAPA</b>            ENGINEER IV</p>	<p><i>Manalili</i>  <b>WILFREDO A. MANALILI</b>            ASSISTANT PROVINCIAL ENGINEER</p>	<p><i>Pangan</i>  <b>OLIMPIO M. PANGAN</b>            PROVINCIAL ENGINEER</p>	<p><b>HON. DENNIS G. PINEDA</b>            GOVERNOR            BY THE AUTHORITY OF THE GOVERNOR:</p> <p><i>Chua</i>  <b>ATTY. CHARLIE G. CHUA</b>            PROVINCIAL ADMINISTRATOR</p>	<p>AS SHOWN</p>	<p>03            07</p>

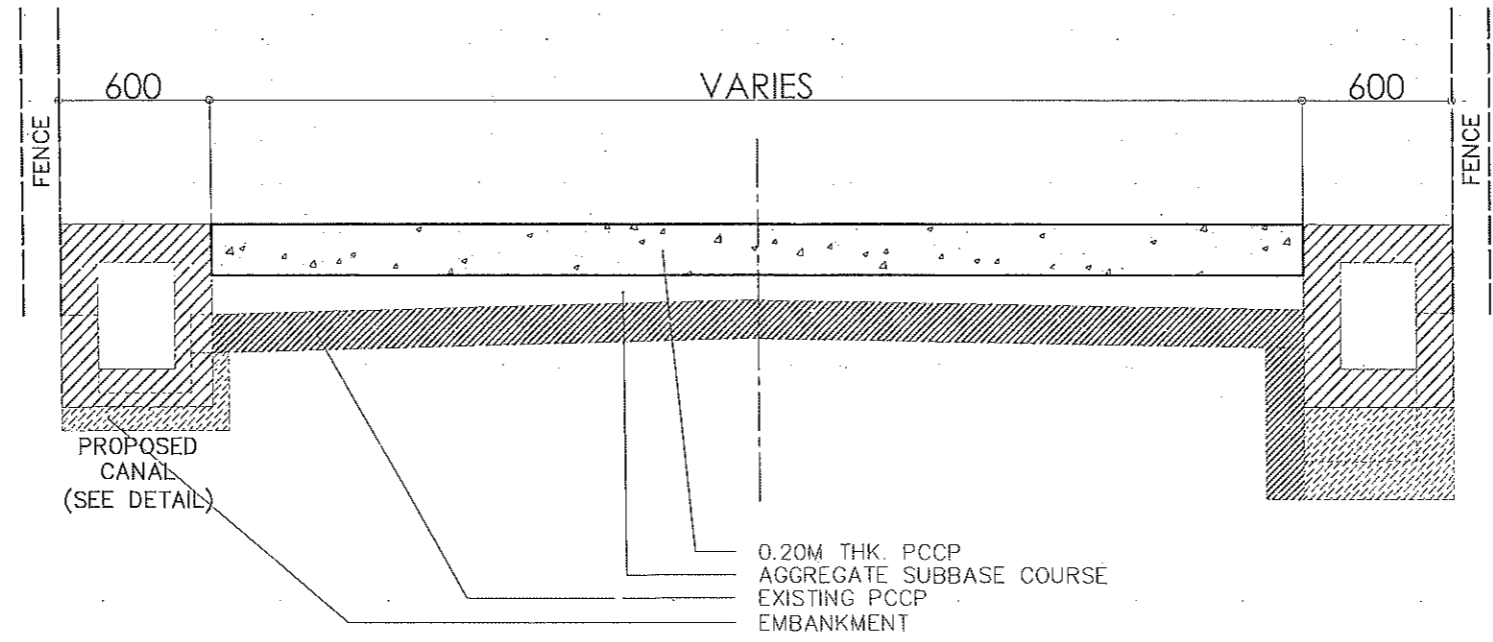

TYPICAL SECTION 

SCALE 1:30

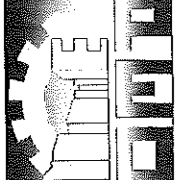
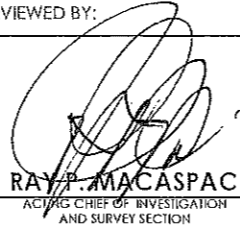

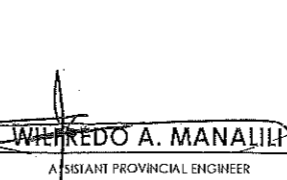
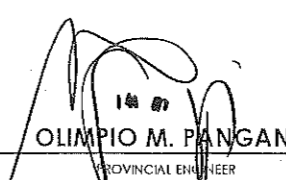
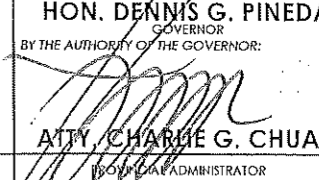
IMPLEMENTING AGENCY:	PROJECT TITLE:	PREPARED BY:	REVIEWED BY:	CHECKED BY:	SUBMITTED BY:	RECOMMENDING AGENCY APPROVAL:	APPROVED BY:	SHEET CONTENT:	SHEET NO.:
 REPUBLIC OF THE PHILIPPINES PROVINCE OF PAMPANGA <b>PROVINCIAL ENGINEER'S OFFICE</b> CAPITAL COMPOUND, STO NINO, CITY OF SAN FERNANDO, PAMPANGA	IMPROVEMENT/CONCRETING OF BARANGAY ROAD LOCATION: SAN NICOLAS, CITY OF SAN FERNANDO, PAMPANGA	<i>Morales</i> <b>CHRISTINE V. MORALES</b> ENGINEER I <i>Danan</i> <b>EDRALIN M. DANAN</b> ENGINEER II	 <b>RAY P. MACASPAC</b> ACTING CHIEF OF INVESTIGATION AND SURVEY SECTION	 <b>ESMERALDO T. GULAPA</b> ENGINEER IV	 <b>WILFREDO A. MANALIL</b> ASSISTANT PROVINCIAL ENGINEER	 <b>OLIMPIO M. PANGAN</b> PROVINCIAL ENGINEER	<b>HON. DENNIS G. PINEDA</b> GOVERNOR BY THE AUTHORITY OF THE GOVERNOR:  <b>ATTY. CHARGE G. CHUA</b> PROVINCIAL ADMINISTRATOR	AS SHOWN	04 07

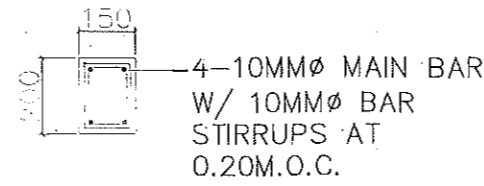
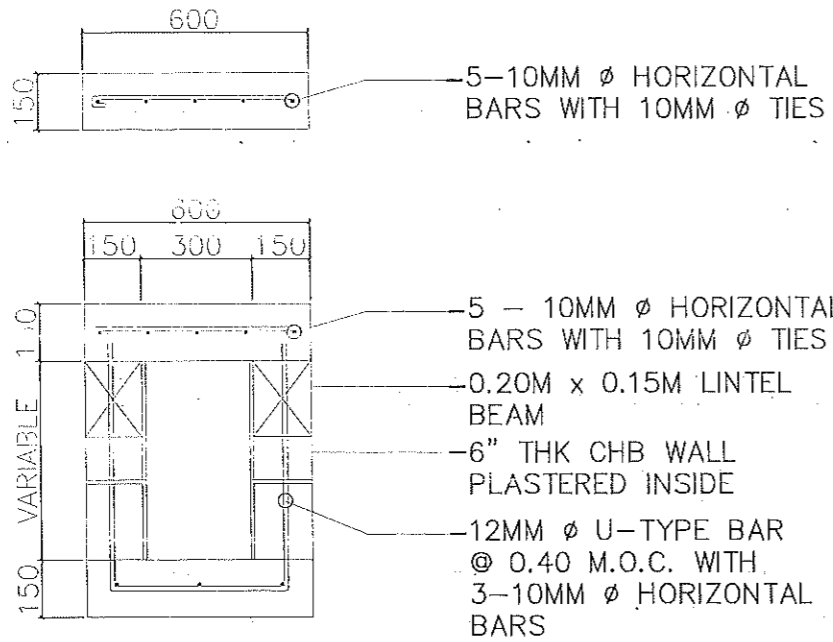

DETAIL OF LINTEL BEAM  
SCALE 1:20

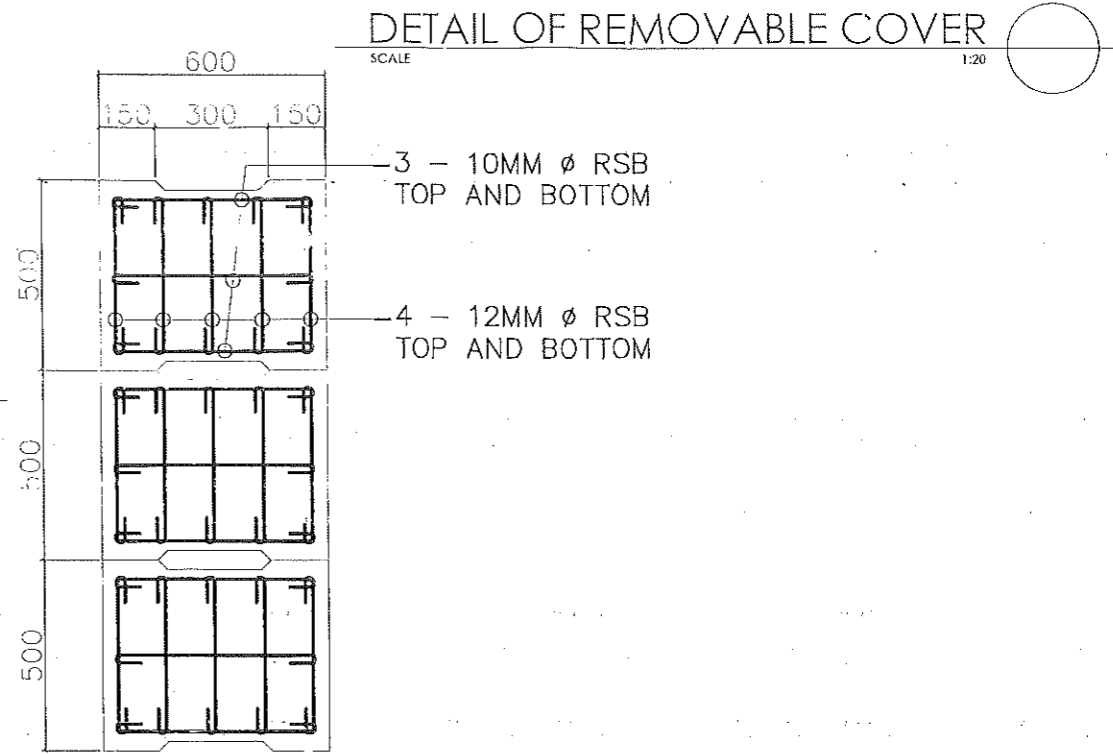

DETAIL OF REMOVABLE COVER  
SCALE 1:20

TYPICAL SECTION  
SCALE 1:20

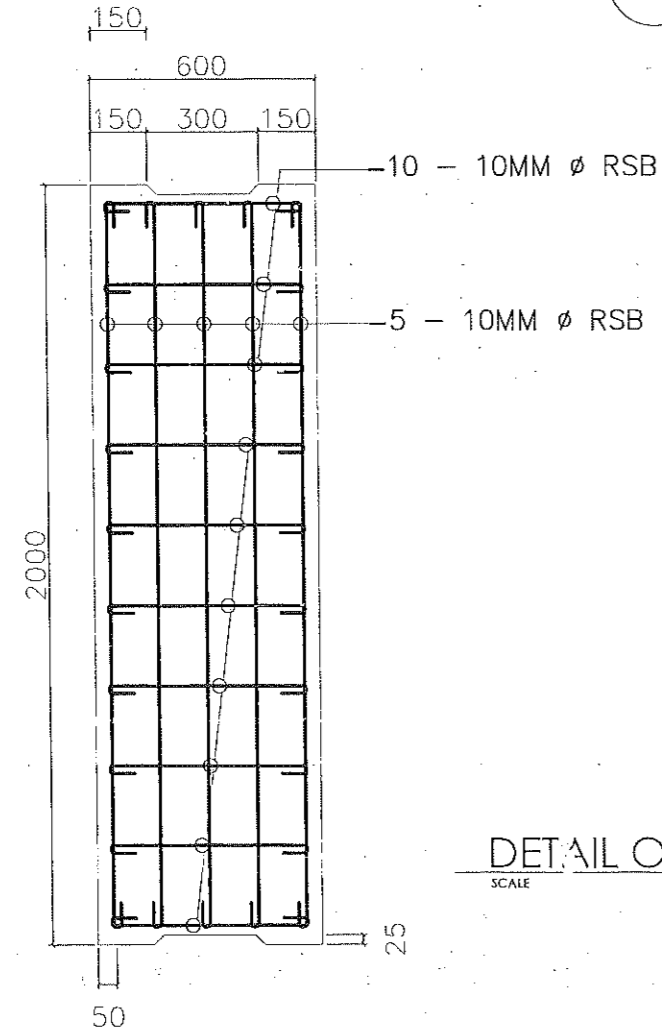

DETAIL OF FIXED COVER  
SCALE 1:20

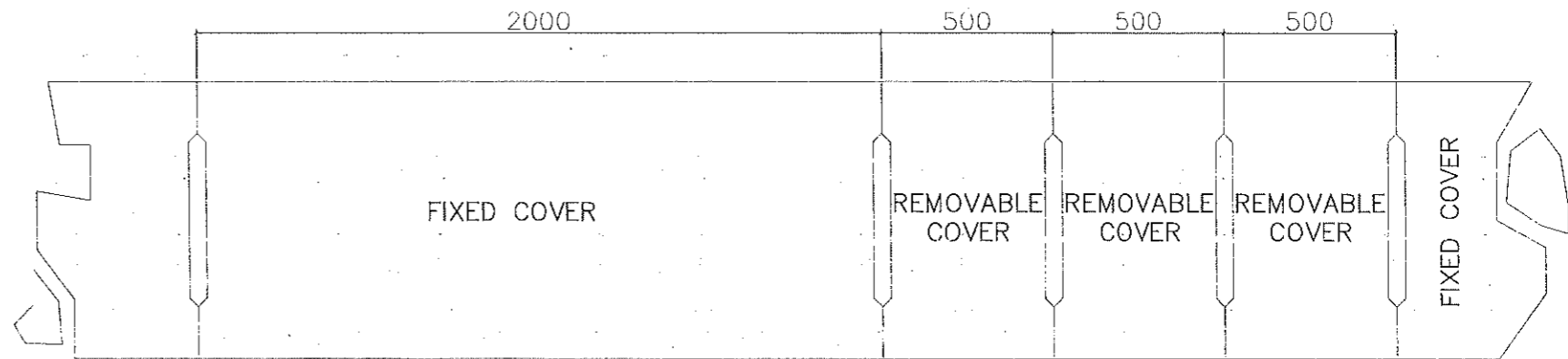

PLAN OF CANAL COVER  
SCALE NTS

CHB LINE CANAL SCHEDULE							
LEFT SIDE				RIGHT SIDE			
STATION LIMITS	TYPE OF DITCH	LENGTH m	DIRECTION OF FLOW	STATION LIMITS	TYPE OF DITCH	LENGTH m	DIRECTION OF FLOW
FROM	TO			FROM	TO		
0+000	0+204.70	U-SHAPED	←	0+000	0+204.70	U-SHAPED	←

IMPLEMENTING AGENCY: REPUBLIC OF THE PHILIPPINES PROVINCE OF PAMPANGA PROVINCIAL ENGINEER'S OFFICE CENTRAL COMBINED, STONING, CITY OF SAN FERDINAND, PAMPANGA	PROJECT TITLE: IMPROVEMENT/CONCRETING OF BARANGAY ROAD LOCATION: SAN NICOLAS, CITY OF SAN FERDINAND, PAMPANGA	PREPARED BY: CHRISTINE V. MORALES ENGINEER I EDRALIN M. DANAN ENGINEER II	REVIEWED BY: RAY P. MACASPAC ACTING CHIEF OF INVESTIGATION AND SURVEY SECTION	CHECKED BY: ESMERALDO T. GULAPA ENGINEER IV	SUBMITTED BY: WILFREDO A. MANALILI ASSISTANT PROVINCIAL ENGINEER	RECOMMENDING APPROVAL: OLIMPIO M. MANGAN PROVINCIAL ENGINEER	APPROVED BY: HON. DENNIS G. PINEDA GOVERNOR BY THE AUTHORITY OF THE GOVERNOR: ATTY. CHARLIE G. CHUA PROVINCIAL ADMINISTRATOR	SHEET CONTENT: AS SHOWN	SHEET NO.: 05 07
---	--	---	--	---	--	--	---	----------------------------	------------------------

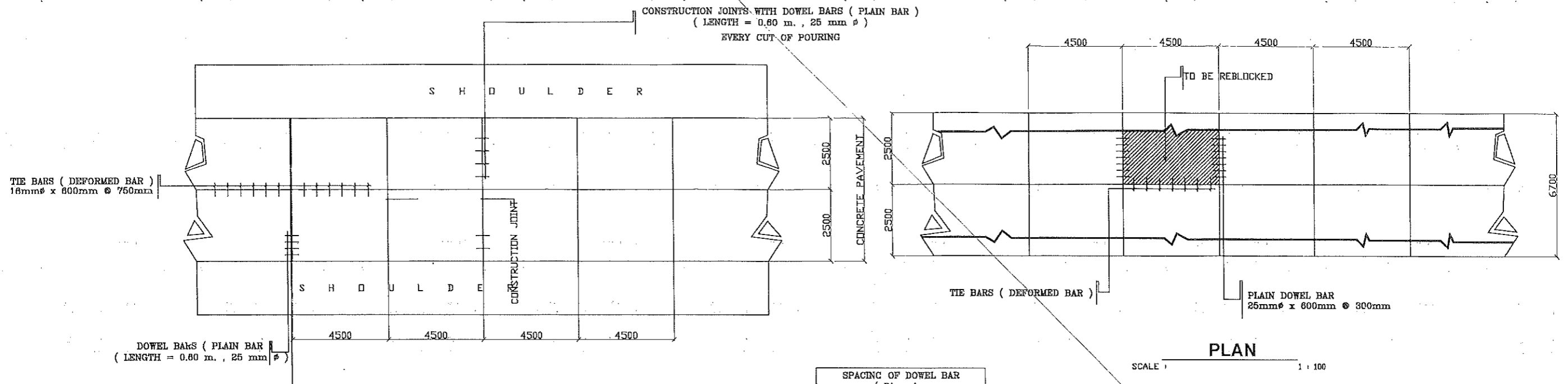

**PAVEMENT LAYOUT PLAN**  
SCALE: 1:200

SPACING OF DOWEL BAR (Diameter 25mm/Length=600mm)	
SLAB DEPTH, (T) (mm)	SPACING (mm)
200	300
250	200
300	150

SPACING OF TIE BARS (Diameter 16 mm/Length=600 mm)	
SLAB DEPTH, (T) (mm)	SPACING (mm)
200	750
250	750
300	750



**CONSTRUCTION JOINT SECTION**

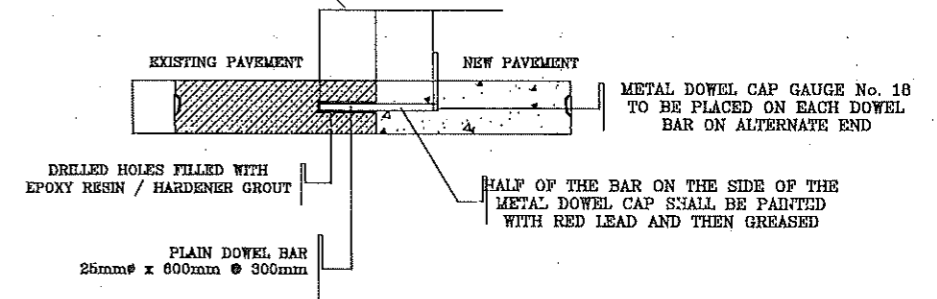

**SECTION**  
DETAIL OF EXPANSION JOINT (DOWELLED) AT CERTAIN INTERSECTION & STRUCTURES  
SCALE: 1:40

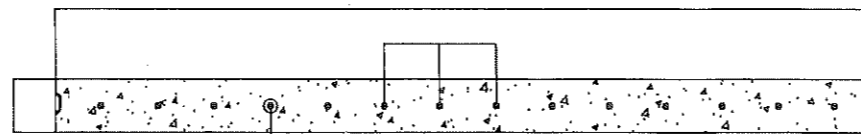

**ELEVATION**  
SCALE: 1:20

IMPLEMENTING AGENCY: REPUBLIC OF THE PHILIPPINES PROVINCE OF PAMPANGA <b>PROVINCIAL ENGINEER'S OFFICE</b> CAPITOL COMPOUND, 510 NEDRA, CITY OF SAN FERNANDO, PAMPANGA	PROJECT TITLE: <b>IMPROVEMENT/CONCRETING OF BARANGAY ROAD</b> LOCATION: SAN NICOLAS, CITY OF SAN FERNANDO, PAMPANGA	PREPARED BY: <i>Morales</i> <b>CHRISTINE V. MORALES</b> ENGINEER I <i>Danan</i> <b>EDRALIN M. DANAN</b> ENGINEER II	REVIEWED BY: <i>Macaspac</i> <b>RAY P. MACASPAC</b> ACTING CHIEF OF INVESTIGATION AND SURVEY SECTION	CHECKED BY: <i>Gulapa</i> <b>ESMERALDO T. GULAPA</b> ENGINEER IV	SUBMITTED BY: <i>Manalili</i> <b>WILFREDO A. MANALILI</b> ASSISTANT PROVINCIAL ENGINEER	RECOMMENDING APPROVAL: <i>Pangan</i> <b>OLIMPIO M. PANGAN</b> PROVINCIAL ENGINEER	APPROVED BY: <b>HON. DENNIS G. PINEDA</b> GOVERNOR BY THE AUTHORITY OF THE GOVERNOR: <i>Chua</i> <b>ATTY. CHARLIE G. CHUA</b> PROVINCIAL ADMINISTRATOR	SHEET CONTENT: AS SHOWN	SHEET NO: 06 07
---	---	---	--	---	--	--	--	----------------------------------	-----------------------

# DESIGN STANDARD FOR PORTLAND CEMENT CONCRETE PAVEMENT (3.00 - 4.00M WIDTH)

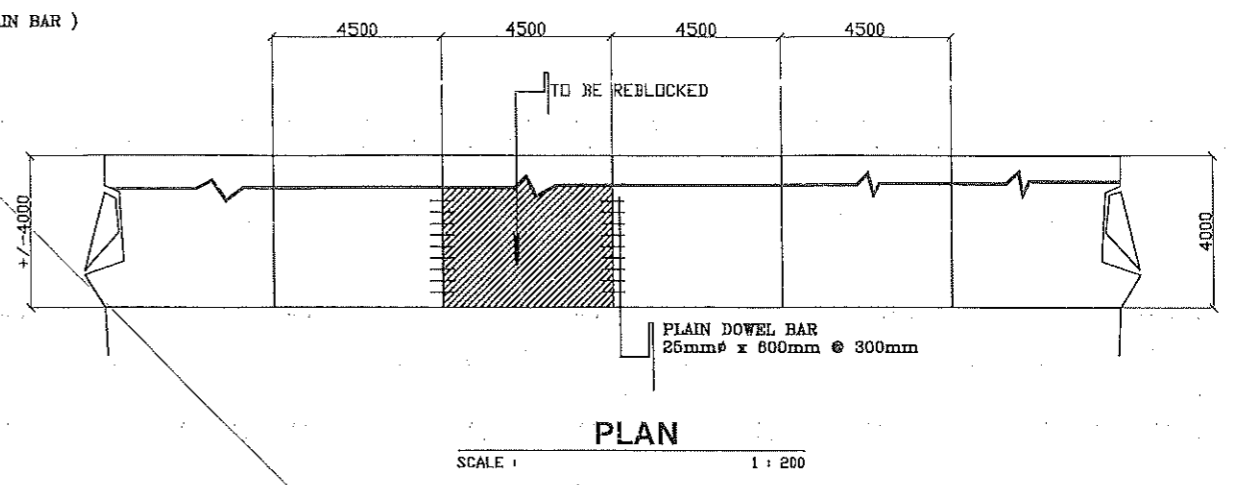
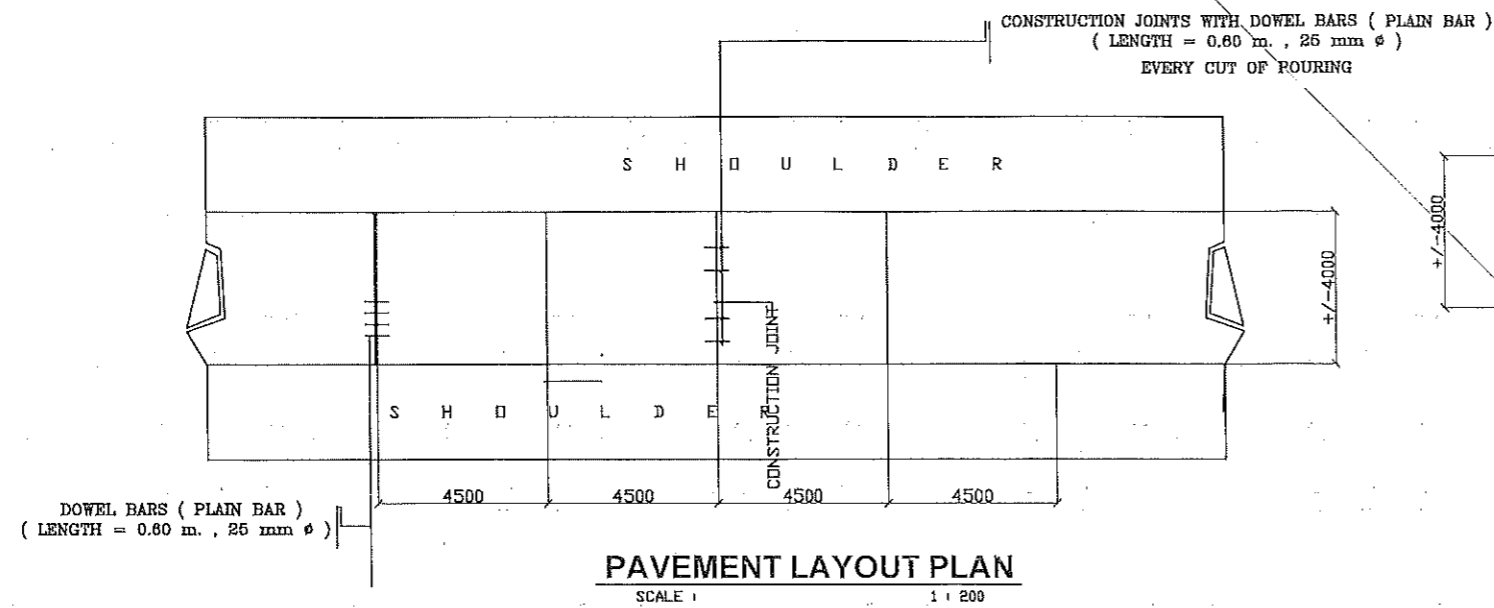

SPACING OF DOWEL BAR (Diameter 25mm/Length=600mm)	
SLAB DEPTH, (T) (mm)	SPACING (mm)
200	300
250	300
300	300

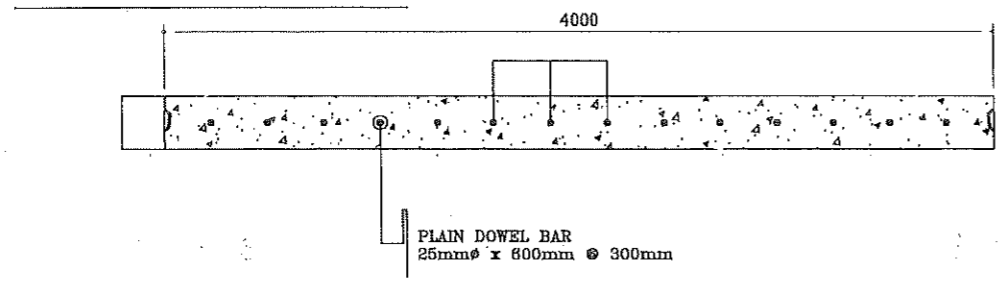
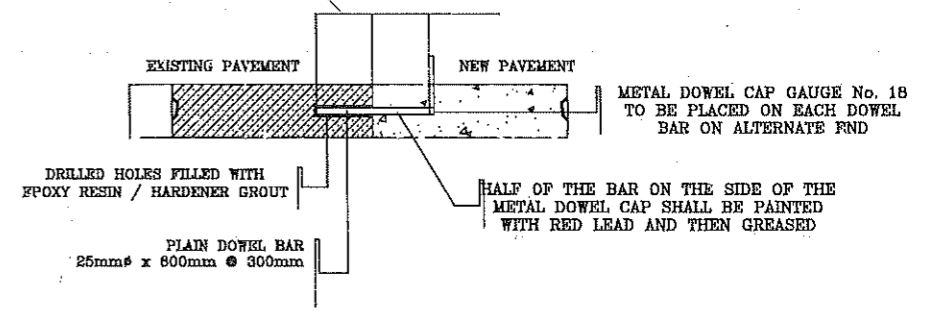
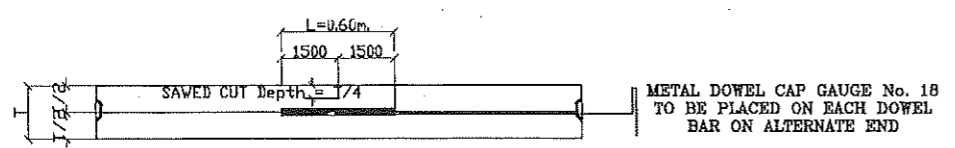

IMPLEMENTING AGENCY:	PROJECT TITLE:	PREPARED BY:	REVIEWED BY:	CHECKED BY:	SUBMITTED BY:	RECOMMENDING APPROVAL:	APPROVED BY:	SHEET CONTENT:	SHEET NO.:
REPUBLIC OF THE PHILIPPINES PROVINCE OF PAMPANGA  <b>PROVINCIAL ENGINEER'S OFFICE</b>  <small>CANTON COMPOUND, STU 2350, CITY OF SAN FERNANDO, PAMPANGA</small>	IMPROVEMENT/CONCRETING OF BARANGAY ROAD  <small>LOCATION: SAN NICOLAS, CITY OF SAN FERNANDO, PAMPANGA</small>	 <b>CHRISTINE V. MORALES</b> ENGINEER I	 <b>RAY P. MACASPAC</b> <small>ACTING CHIEF OF INVESTIGATION AND SURVEY SECTION</small>	 <b>ESMERALDO T. GULAPA</b> ENGINEER IV	 <b>WILFREDO A. MANALILI</b> <small>ASSISTANT PROVINCIAL ENGINEER</small>	 <b>OLIMPIO M. PANGAN</b> <small>PROVINCIAL ENGINEER</small>	HON. DENNIS G. PINEDA <small>GOVERNOR</small> BY THE AUTHORITY OF THE GOVERNOR:	AS SHOWN	07 07
		<small>CANTON COMPOUND, STU 2350, CITY OF SAN FERNANDO, PAMPANGA</small>					 <b>EDRALIN M. DANAN</b> ENGINEER II		